



# Niko Home Control

Your home works better with Niko

***niko***





# Contents

Contents .....	1
Your home works better with Niko Home Control .....	3
Make every home smart with Niko Home Control .....	4
Any use case, always a solution .....	6
Niko Home Control for bus wiring .....	10
Niko Home Control, wireless for 230V .....	12
The Niko Academy .....	14
Niko Home Control online .....	15
Niko Home Control ecosystem .....	16





11:53

### My live energy flow

[See history](#)



You don't have enough production to satisfy your demand, if possible delay your consumption.

### My energy details today

- Electricity (gr...)
- Gas
- TV & Decoder
- Favourites
- Control
- Energy
- Access
- Climate



# Your home works better with Niko Home Control

**Optimise Comfort, Safety, and Energy Efficiency with Niko Home Control.** Niko Home Control is a centralised building automation system that integrates lighting, heating, ventilation, EV charging, shutters, air conditioning, and management of home appliances into one intuitive platform. Designed for effortless installation and configuration, it offers a consistent user experience across all controls—whether at home or remotely. With a future-proof, timeless design and a focus on energy efficiency, Niko Home Control empowers installers to deliver a smarter, safer, and more sustainable living environment.

New buildings, conversions, major and minor renovations: **thanks to Niko Home Control you can fulfil every home automation requirement, suiting every project, budget and customer.** For your customers with new buildings, conversions or major renovations, Niko Home Control for **bus wiring** is the ideal solution. The flexibility of the system provides them with endless possibilities for expansion in the future. For customers who want to make their home smart without any demolition or want to do partial renovations on a limited budget, Niko Home Control can be installed on **traditional wiring**. And if your customer wants to have a partial newbuild extension to his existing house you can now provide him a **hybrid Niko Home Control system** by combining our solution for bus wiring seamless with the product on traditional wiring.

## Smart open system

Do your customers have smart systems from other brands in their home? Niko Home Control is easy to connect to the systems from over 100 **high-quality partners**. In 1,2,3 your customer can adjust the sun blinds, open a rooftop window from the ground floor, control the air quality any time of day or control their Sonos music installation.

## Belgian quality and expertise

With **100 years of experience**, including over 30 years in home automation, you're choosing genuine Belgian expertise. Niko also has a great reputation across Europe. Innovation and quality are at the heart of everything we do.



# Make every home smart with Niko Home Control

With Niko Home Control you have a solution to help all your customers make their home smart. Whether you install Niko Home Control on bus wiring or traditional wiring or a combination of both, you always use the same platform and the same user-friendly programming software. Your customer also controls their installation with the same intuitive Niko Home app.

## Bus Wiring: complete home automation, endless possibilities and flexible control

Is your customer building a new house or extensively renovating a current home and also replacing the electrical wiring? Then choose the flexibility and future stability of Niko Home Control for bus wiring.

All of the system's components communicate with each other via the connected controller. This makes the system smart, gives it an unlimited number of possibilities and the customers have the flexibility to expand their installation in the future. Do your customers want an extra switch or sensor? They can be easily added without having to adapt the wiring. Do you want to connect smart systems from our partner brands to Niko Home Control? That's also possible with Niko Home Control for bus wiring.

## Hybrid system, the best of both worlds:

Now combine the endless possibilities of a bus wiring system with the benefits of a 230V wiring solution and wireless devices (where there is no possibility to put cables, or plans change in a very late stage of the building process).

Part of the existing wiring can be reused while a newbuild extension of the home can have a full functional bus wiring system. All combined to one system, programmed via one user-friendly programming software, and controlled via one intuitive Niko Home app.

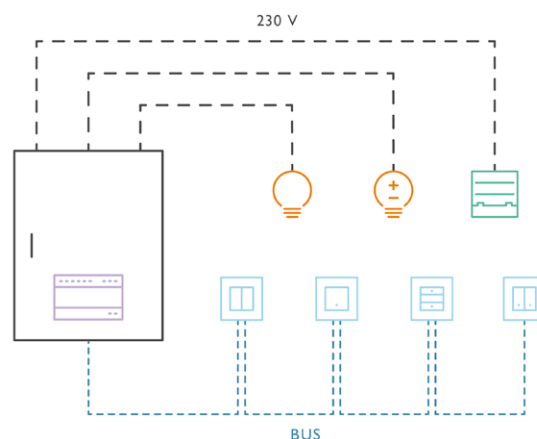



### Wireless on 230V wiring: make your customer's home smart without cutting or breaking

In **existing or new homes with traditional wiring** you can reuse the existing electrical wiring and fuse boxes with Niko Home Control. No extra space is needed in the electrical cabinet. The original switches and socket outlets in the existing installation can be easily replaced by connecting switches and socket outlets that you configure according to your customer's wishes.

Standard functions don't need to be programmed, they work automatically. Do you want to add more functionalities and give your customer more comfort? All you have to do is add **the wireless smart hub**. You can start programming immediately and give your customers almost the same possibilities as an installation with bus wiring. And because your customer's existing system is reused, you can offer them Niko Home Control without the added costs for new wiring. Do you want to connect smart systems from our partner brands to Niko Home Control? That's also possible with Niko Home Control for traditional wiring.

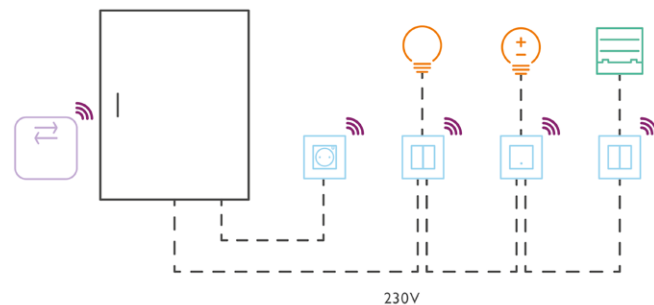



# Any use case, always a solution



## Easy lighting control

There are many routines in your home that can be automated, like switching the lights on and off whenever you enter or leave the house. Discover all the great things you can do when you embrace Niko Home Control.



## Energy efficiency

A smart energy management system (EMS) like Niko Home Control can really help you optimise your energy efficiency. Besides the many smart energy saving functionalities, you'll also have insights into how much electricity you consume and produce yourself. On top of that you can automatically match your consumption to your production and spread your usage over the entire day.



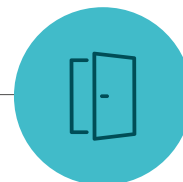

### Secure access control

Niko's digital access control gives you full control over your front door or gate from a central place in your home via a touchscreen or from anywhere in the world, with your smartphone.



### Smart climate control

Besides being integral to comfort, heating and cooling is a significant part of a home's energy consumption. Niko has developed a solution to help families choose the appropriate temperature level according to the needs of every room in their home, enabling families to save up to 20% in their heating and cooling costs.





# The Niko Home Control functional overview

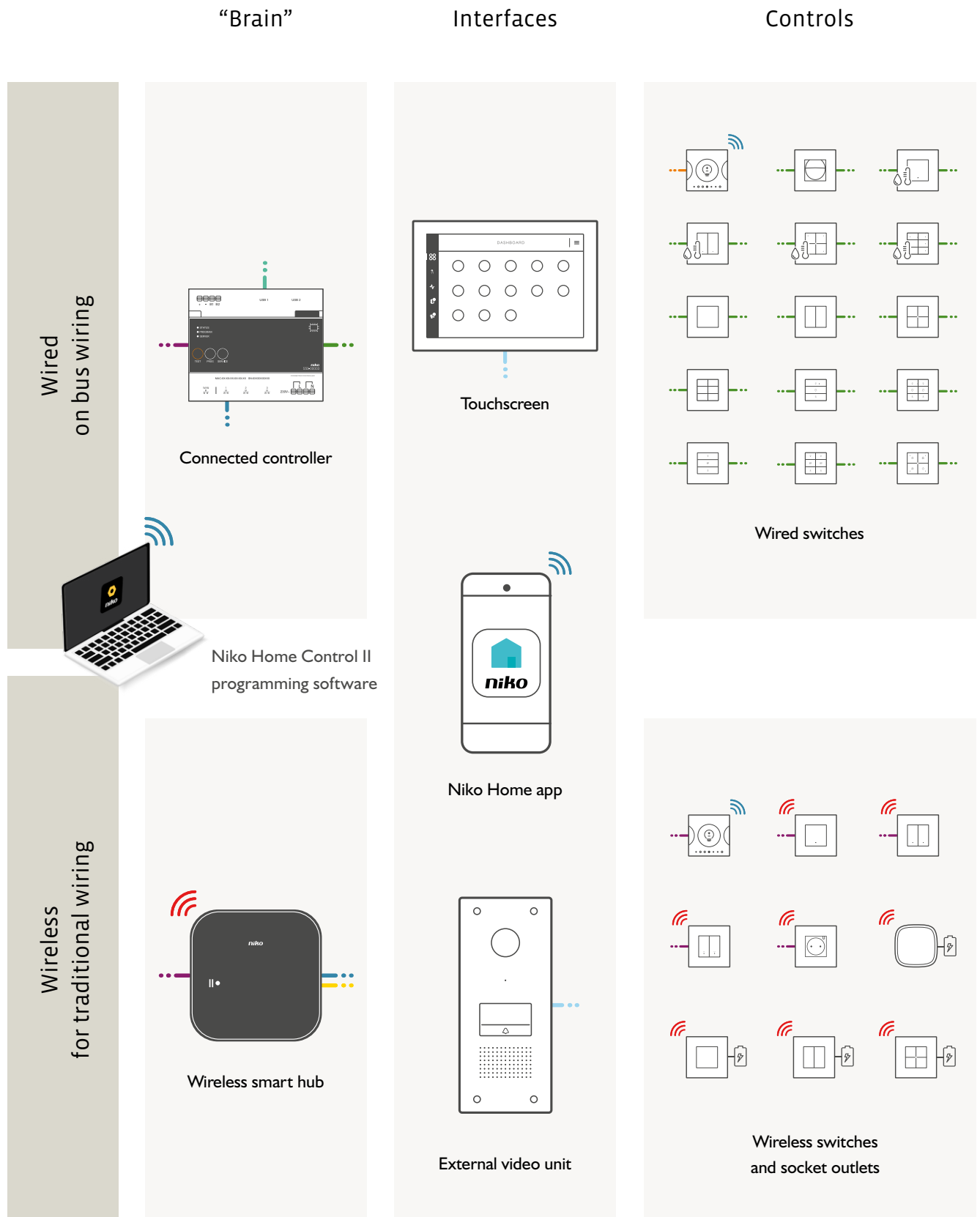

--- 230 V    --- 24 V    --- BUS    --- UTP    --- USB    --- PoE/UTP    --- P1    
 Zigbee®    WiFi    with battery

## Insights in energy production and energy use



### Measuring module bus

To measure 1- and 3-phase, for consumption, injection and production

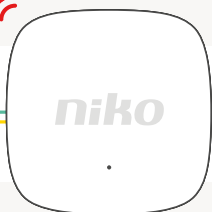

The **wireless bridge** for extending your bus system with wireless products



### Wireless measuring module

To measure 1- and 3-phase, for consumption, injection and production



### Connected switching socket outlet or smart plug

To measure specific consumption

## Controlling equipment and systems

### Cabinet modules

- Switching modules
- Universal Dimmer module
- Motor modules
- HVAC module
- Ventilation module
- Analogue control module
- DALI modules



### Wallmounted devices

- Connected switching socket outlet
- Smart plug
- Connected switch
- Connected motor control
- Connected dimmer

## Niko Home Control ecosystem

### Climate control



### Charging stations



### Ventilation



### Windows and doors



### Inverter



### Audio



works with



works with the  
Google Assistant



amazon alexa



# Niko Home Control for bus wiring

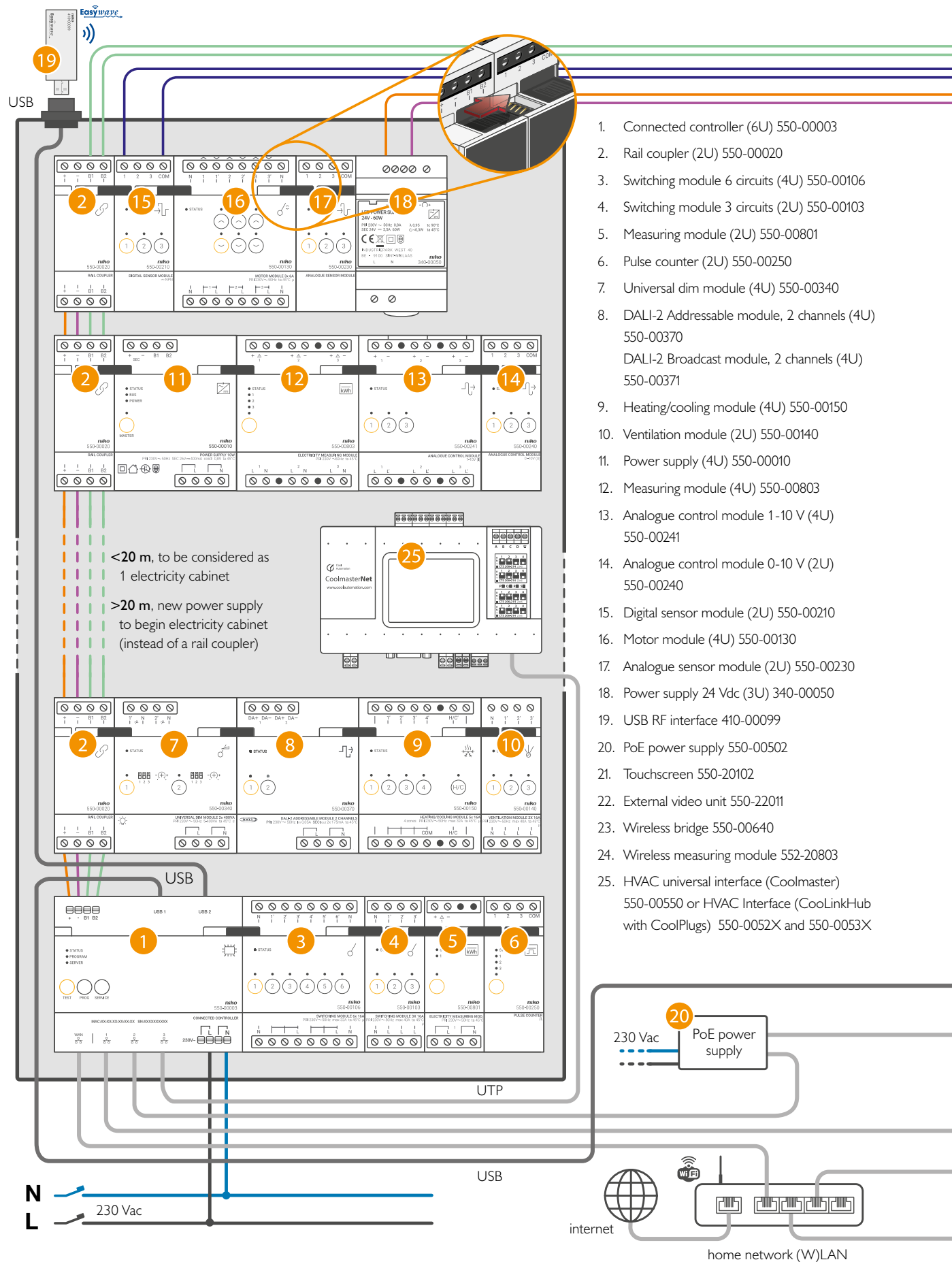

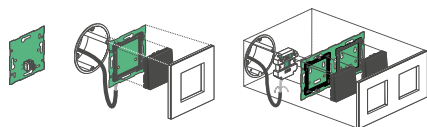

two-wire, non-polarised - free topology

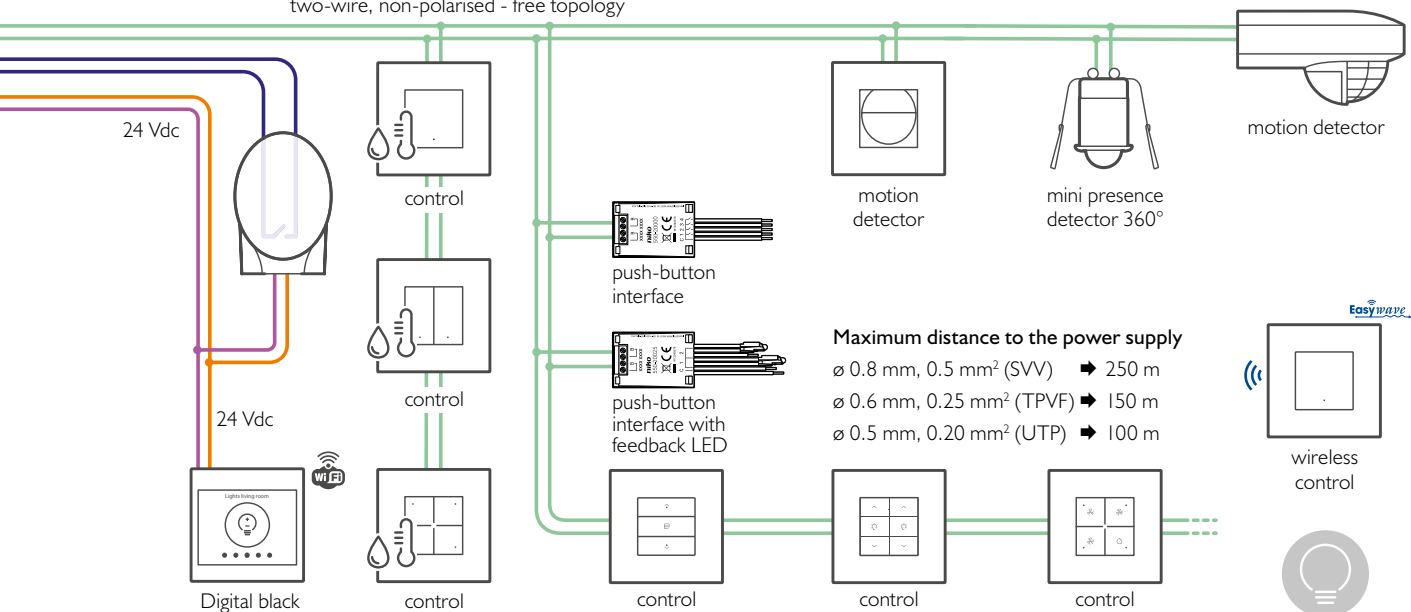

#### Maximum distance to the power supply

- ∅ 0.8 mm, 0.5 mm<sup>2</sup> (SVV) → 250 m
- ∅ 0.6 mm, 0.25 mm<sup>2</sup> (TPVF) → 150 m
- ∅ 0.5 mm, 0.20 mm<sup>2</sup> (UTP) → 100 m

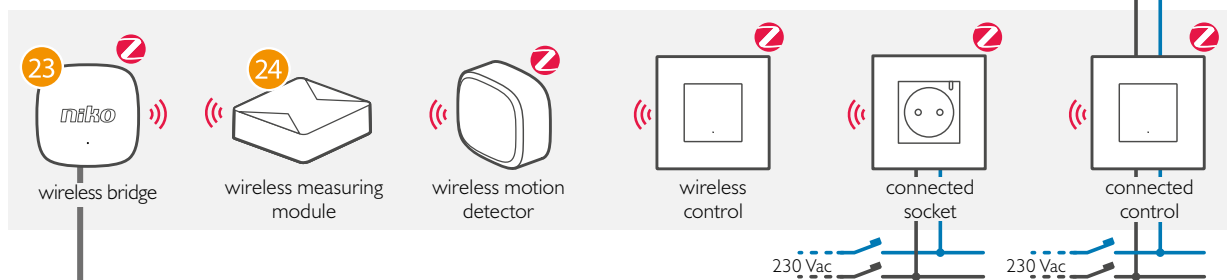

guide.niko.eu

#### Consumer ecosystems

amazon alexa

works with the Google Assistant

- External partners connected via local IP, the cloud or a dedicated Niko Home Control module.



www.niko.eu/partners



EV chargers



PV and battery inverters

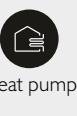

heat pump



airco

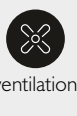

ventilation



windows and window coverings



doors

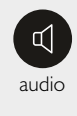

audio

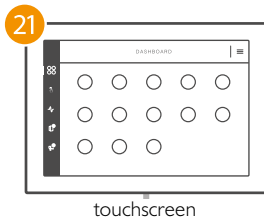
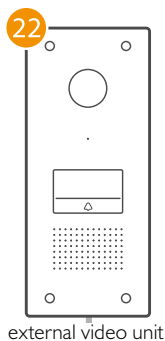

twisted pair cable (UTP, FTP or STP)

#### Wireless protocols

Wifi



Zigbee®



Easywave





# Niko Home Control, wireless for 230V

## Battery-powered components

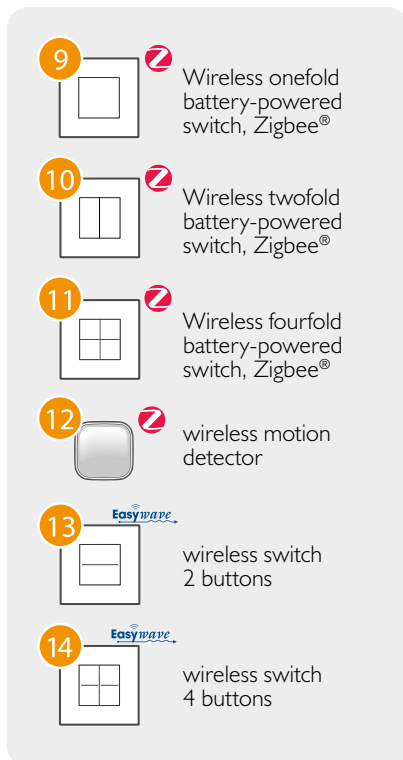

1. Wireless smart hub for Niko Home Control 552-00001
2. Connected single switch 552-72101 / 552-72111 / 552-72121
3. Connected double switch 552-72102 / 552-72112 / 552-72122
4. Connected dimmer 552-72201 / 552-72211 / 552-72221
5. Connected motor control 552-72301 / 552-72311 / 552-72321
6. Digital black connected control screen 551-18000 / 551-18001
7. Connected switching socket outlet, Zigbee® 170-33505 / 170-33605 / 170-34505 / 170-34605
8. Smart plug, Zigbee® 552-80698 / 552-80699
9. Wireless onefold battery-powered switch, Zigbee® 552-72001 / 552-72011
10. Wireless twofold battery-powered switch, Zigbee® 552-72002 / 552-72012
11. Wireless fourfold battery-powered switch, Zigbee® 552-72004 / 552-72014
12. Wireless motion detector, Zigbee® 552-80401
13. Wireless switch 2 buttons 410-00001
14. Wireless switch 4 buttons 410-00002
15. External video unit 550-22011
16. Touchscreen 550-20102
17. PoE power supply 550-00502
18. Push button N.O. 170-00000 / 170-00001 / 170-00005 / 170-00015 / 170-70000 / 170-70001 / 170-70005 / 170-70015
19. LED compensator 310-05001
20. Wireless measuring module 552-20803



guide.niko.eu

- Consumer ecosystems



- External partners connected via local IP or via the cloud



www.niko.eu/partners

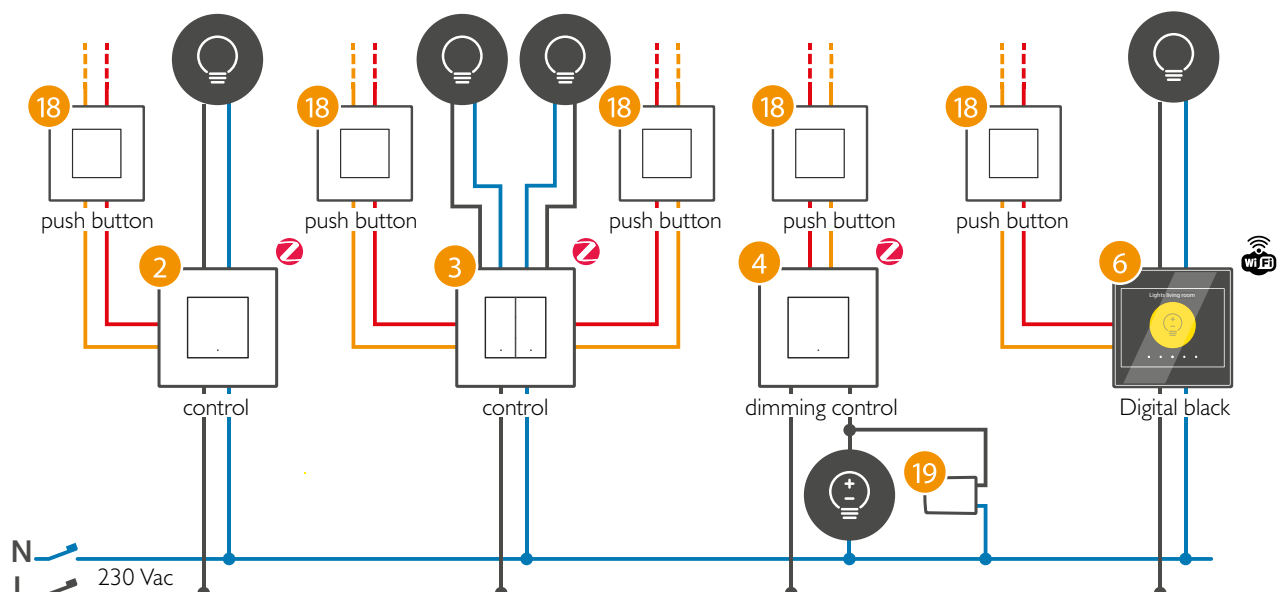

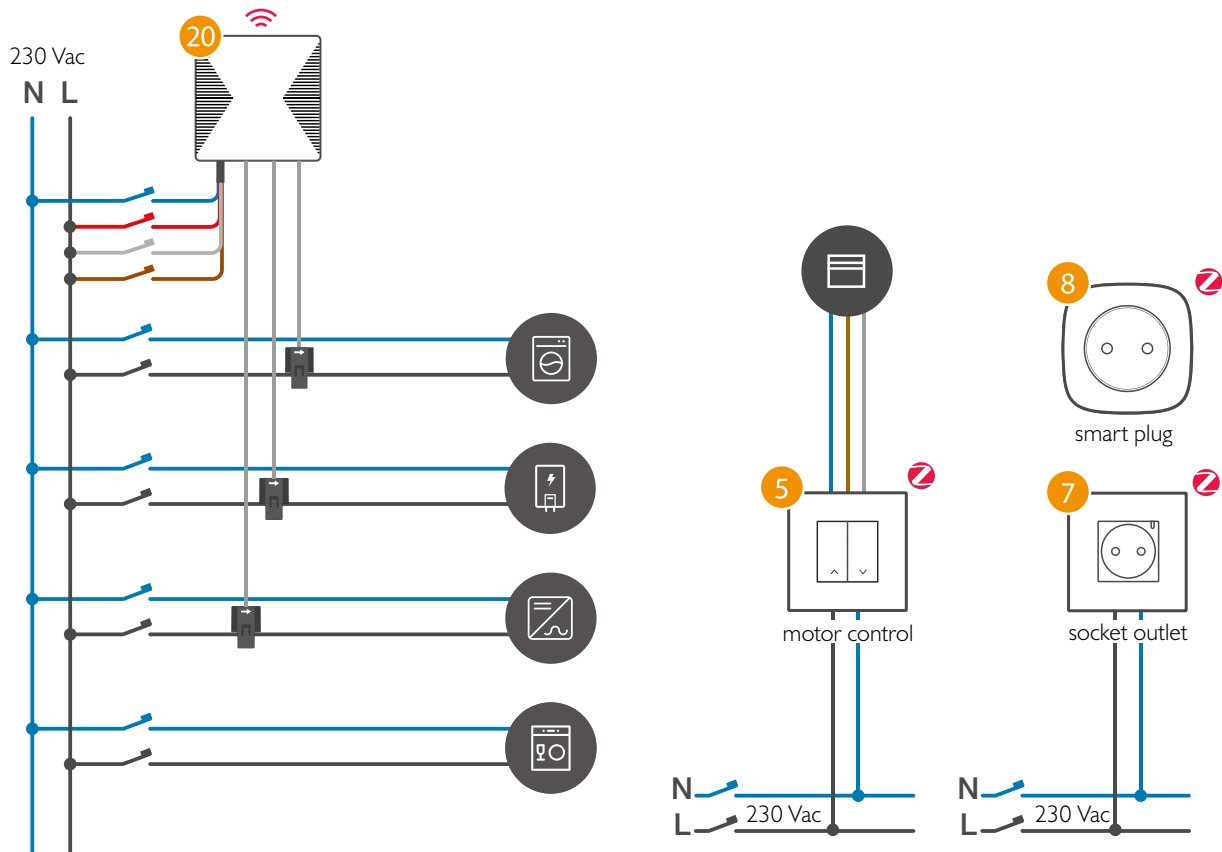
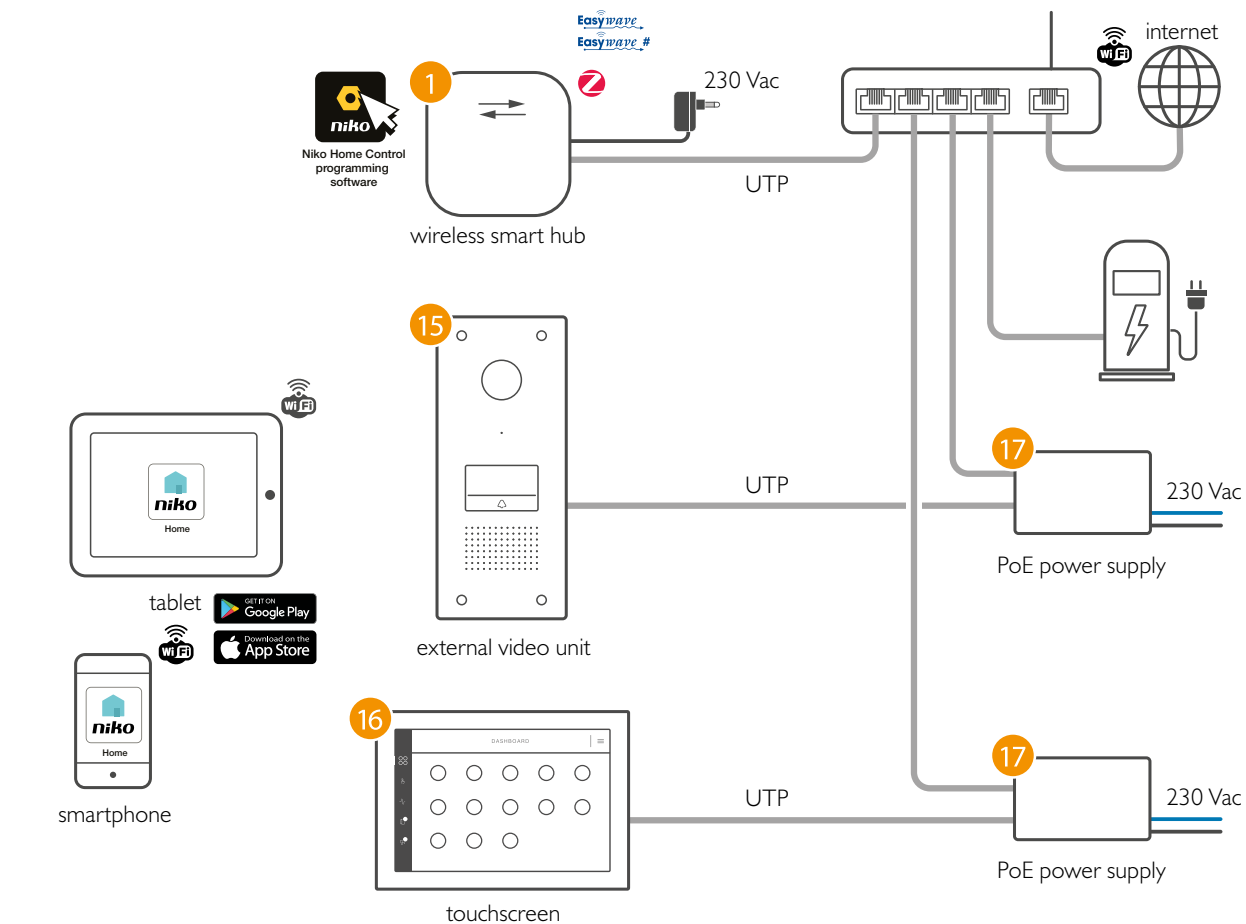

Wireless protocols



Zigbee®



Easywave



Easywave #







# The Niko Academy

## We help you to be the best

Via our Niko Home Control training courses, we help you getting the maximum out of an installation in order to fulfill your end-users demands.. We turn you into a real expert. This ensures that you can give your customers a completely customized installation and provide them with the accompanying service.



More information can be found on [www.niko.eu/training](http://www.niko.eu/training).

# Niko Home Control online

## Website

You can find more information about Niko Home Control on our website on the Niko Home Control page for professionals. This allows you to provide your customer with all necessary information. Here you'll find an overview of our products, information about our showroom, the partner systems you connect Niko Home Control to,... You can also download our brochures there, or have them sent to you free of charge.

More information can be found on [www.niko.eu/NikoHomeControl](http://www.niko.eu/NikoHomeControl).

## Registration

Have your customers register their installation via app or via programming software. It helps you and Niko to better support your customer in case of functionality or security upgrades. They will also receive important updates for their system. This registration is also necessary in order to activate the control with smartphone and/or tablet.

## Niko Guide

The online manual familiarising you step-by-step with the Niko Home Control installation. You can find information on the basic functions, frequently used programming examples and tutorials, the cabinet lay-out and installation manuals. It is a useful guide after the training or during the installation. Surf to [guide.niko.eu](http://guide.niko.eu).

## Programming software

Software for the programming of Niko Home Control installations for bus or traditional wiring. The software is user-friendly, intuitive and visually structured. The software can be downloaded free of charge from [www.niko.eu](http://www.niko.eu). The software is available for Windows and Mac.



# Niko Home Control ecosystem

Niko Home Control is the beating heart of your home, as it lets you monitor and control a range of vital equipment from one central point, either a digital screen in your home, and/or your smartphone.

Choose from a growing list of major brands working within Niko's ecosystem to help you increase your comfort and better manage energy consumption in your home.

## Use your heat / cooling system where and when necessary

Thanks to Niko Home Control, you can now also monitor your heating, cooling and hot water from one central location. You can control all essential heating system functions, and do this remotely too.

Your living room is used at different times from your kitchen or bathroom. After school, your children may play or study in their bedrooms. With Niko Home Control, you heat each room in your home only when it's necessary.



jaga

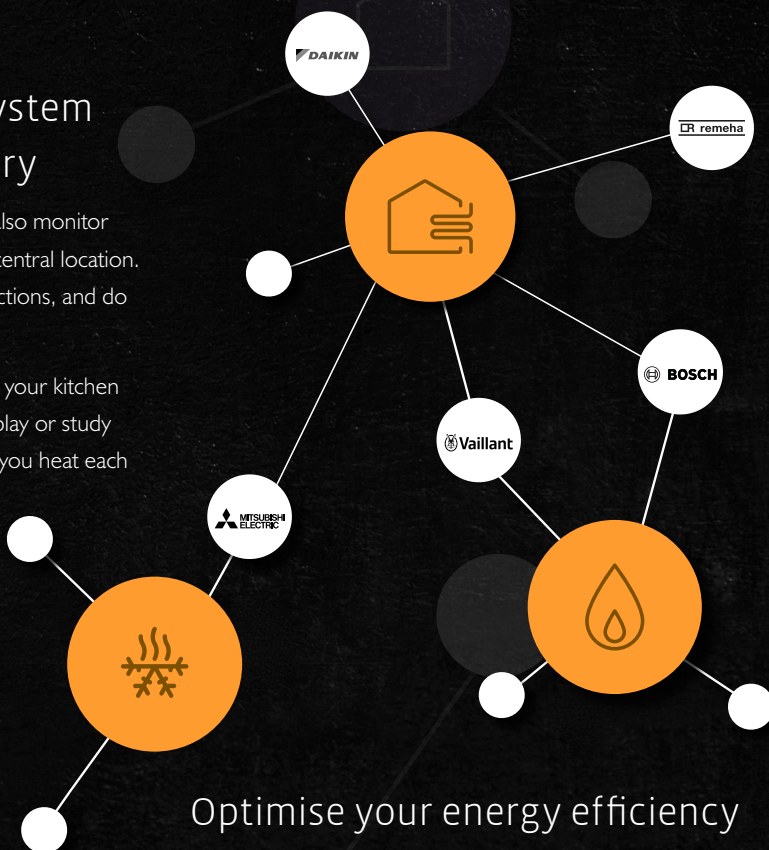
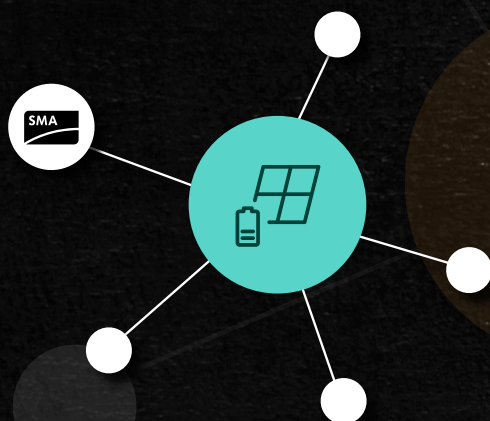

## Optimise your energy efficiency

Get grip on your energy usage, have insights in which devices consume the most, receive alerts and make adjustments where needed.

Automate your energy usage. Thanks to the solar production insights, you can automatically match your consumption to your production and spread your usage over the entire day.

By using smart routines for lighting, heating, EV-charging, socket outlets, ventilation and other installations, Niko Home Control ensures that you have the lowest possible energy consumption. This is good for the environment and for your wallet.

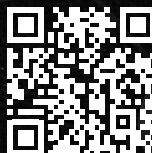



## Open and close windows and sun blinds automatically

Operate your roof windows, electrical sliding windows and sun blinds using Niko Home Control.

The built-in sensor in your roof or sliding window allows you to check on your smartphone whether you have closed the window. It also closes automatically when it starts to rain. With your smartphone you can open the sliding door remotely to let someone in or out.

Using your touchscreen or smartphone, you can open up roof windows and let in some fresh air. In the winter, your roll-down shutters and curtains stay open to let in the sun's warmth. And in the summer, they automatically close to keep the heat at bay. That saves you energy. Switching your home to sleep mode? Your curtains will also close automatically.

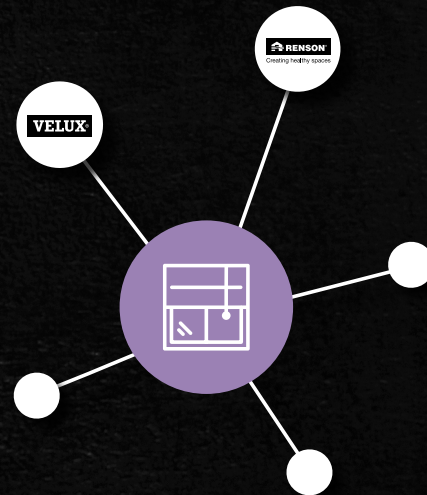

jaga

## Optimise the energy consumption of your EV with Niko Home Control

Charge your electric vehicle at the best time of the day, without any manual intervention, thanks to an integration and partnership with EV wall-charging equipment brands.

Users will be able to track via the Niko Home app how much energy flows to their electric vehicle and easily control the charging cycle in the most energy-efficient way possible. This is a vital step to reducing energy use and costs, as EV chargers are large consumers of power.

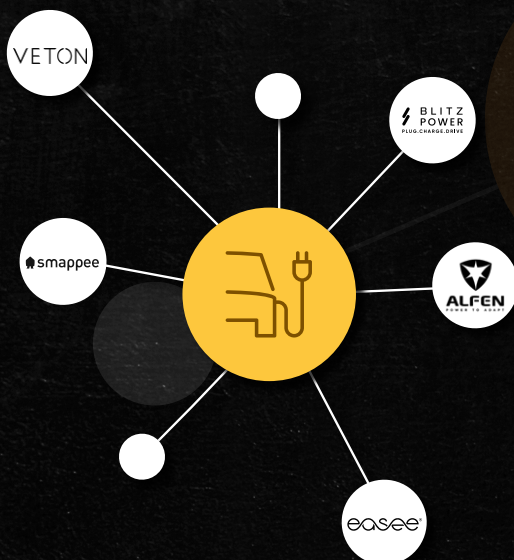

BOSCH

aldes



VETON

BLITZ  
POWER  
PLUG.CHARGE.DRIVE

## Optimise the ventilation in your home

Optimise the ventilation in your home. On the Niko Home Control touchscreen and your smartphone, you can monitor just how healthy the air in your home is and how much CO<sub>2</sub> is present. You can rapidly adjust the ventilation level in one or more rooms or briefly put your ventilation on 'boost'.

Do you wish to automatically decrease your ventilation at bedtime? Or activate economy mode while you spend a weekend at the coast? It's all possible. Thanks to smart ventilation, your ventilation will only work when it's necessary. This stops you from wasting energy

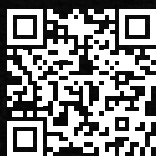

MENNEKES

easee

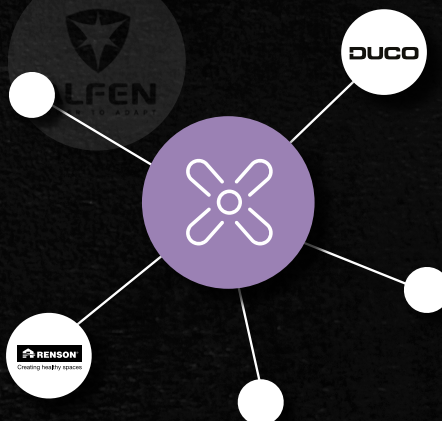

## Take your sound system to a new level

With just one press of the button, you not only put on the lights at the right level and turn the ventilation up or down, you also activate the music from your favourite playlist when you arrive home. You can use the all-off button to e.g. turn off your sound system and lights when you go out.

Is someone at the door? In order to ensure that you don't miss the doorbell, the volume immediately goes down when the doorbell rings. Unwelcome visitors? Your audio system puts your music on extra loud to frighten them away.

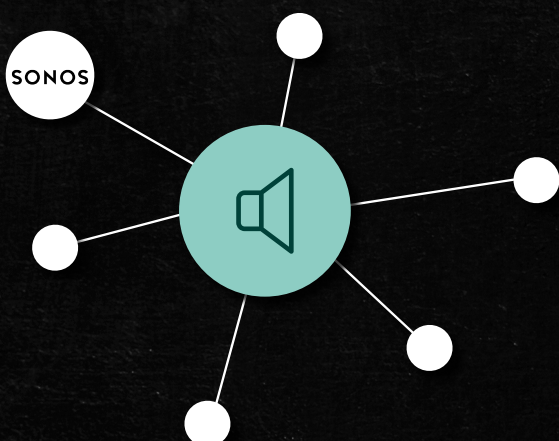



## Keep your cool when your hands are full

Use voice activation like Amazon Alexa or Google Assistant to switch and dim lights, activate alarm settings and control the temperature.

### All you have to do is ask

Niko Home Control now seamlessly connects with the voice control solutions Google Assistant and Amazon Alexa for true, hands-free control of your home's electrical installation.

Simply say the word and Niko Home Control will do just about anything you ask it.



Read more about our partnerships  
[www.niko.eu/partners](http://www.niko.eu/partners)

## Discover our Niko Home Control ecosystem with more than 100 compatible brands.

Next to these partnerships, Niko also connects other brands. We have bundled all information in our Niko guide, where you can find all types of technical information & use cases. This comprehensive resource ensures that you have access to everything you need for your smart inverter solutions.

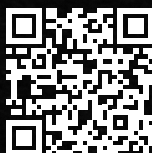



Niko designs electr(on)ic solutions to enhance buildings to better suit the needs of the people who live and work in them. By using less energy, by improving light comfort and safety and by making sure all applications work together seamlessly. Buildings with Niko are more efficient, are controllable from a distance and interact within bigger ecosystems. Niko is a Belgian family business from Sint-Niklaas with 700 employees and 10 European branches.

At Niko, there is one question that keeps us busy every day: "How can we enhance buildings to better suit your needs?"

**Wygwam, a division of Niko NV**

Desguinlei 100 bus 7

2018 Antwerpen

Belgium

[sales.be@niko.eu](mailto:sales.be@niko.eu)

+32 3 778 90 00

[www.wygwam.com](http://www.wygwam.com)

**niko**

PF-1660-11