

Presence detector, KNX®, 4 channels, 16 m, for flush-mounting box

351-25039

4 year
warranty

The presence detector with four channels and daylight control for flush-mounting box in ceilings is suitable for switching the indoor lighting on and off. The detector is equipped with an integrated light sensor and is only compatible with KNX®.



- Combination of master/secondary possible
- Can be placed at a height of up to 8 metres
- - Very good and sensitive detection

Presence detector for use in meeting rooms, offices, etc.

- Everything can be programmed using ETS software
- Very simple programming
- Can be programmed as a presence or absence detector
- 2 channels for setting by heliometer
 - 1 channel for turning the lighting on and off
 - 1 channel for turning the HVAC installation on and off

Technical data

Article number	351-25039
Configuration	master/secondary
Input voltage	30 Vdc via KNX®-bus
Detector output	KNX®
Maximum power consumption	0.3 W
Maximum current consumption	10 mA
Light intensity range	10 lux – 2000 lux
Number of channels	4 channels
Switch-off delay	1 s – 4 h
Detection angle	360°
Detection range (PIR)	ø 16 m from a height of 3 m
Ambient temperature	-20 – +40 °C
Mounting method	flush-mounting
Mounting height	2 – 8 m
Dimensions (HxWxD)	120 x 120 x 49 mm
Impact resistance	IK02
Modification of settings	ETS software
Marking	CE

Dimensions

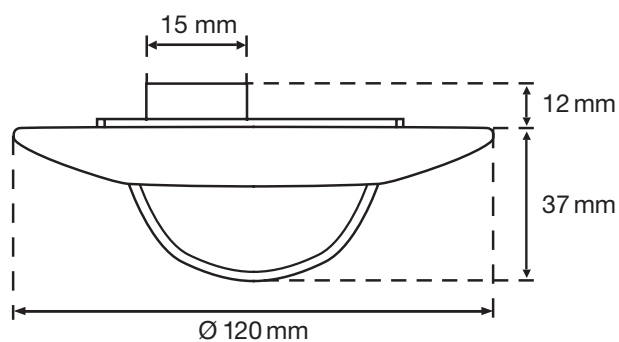

Wiring diagram

