

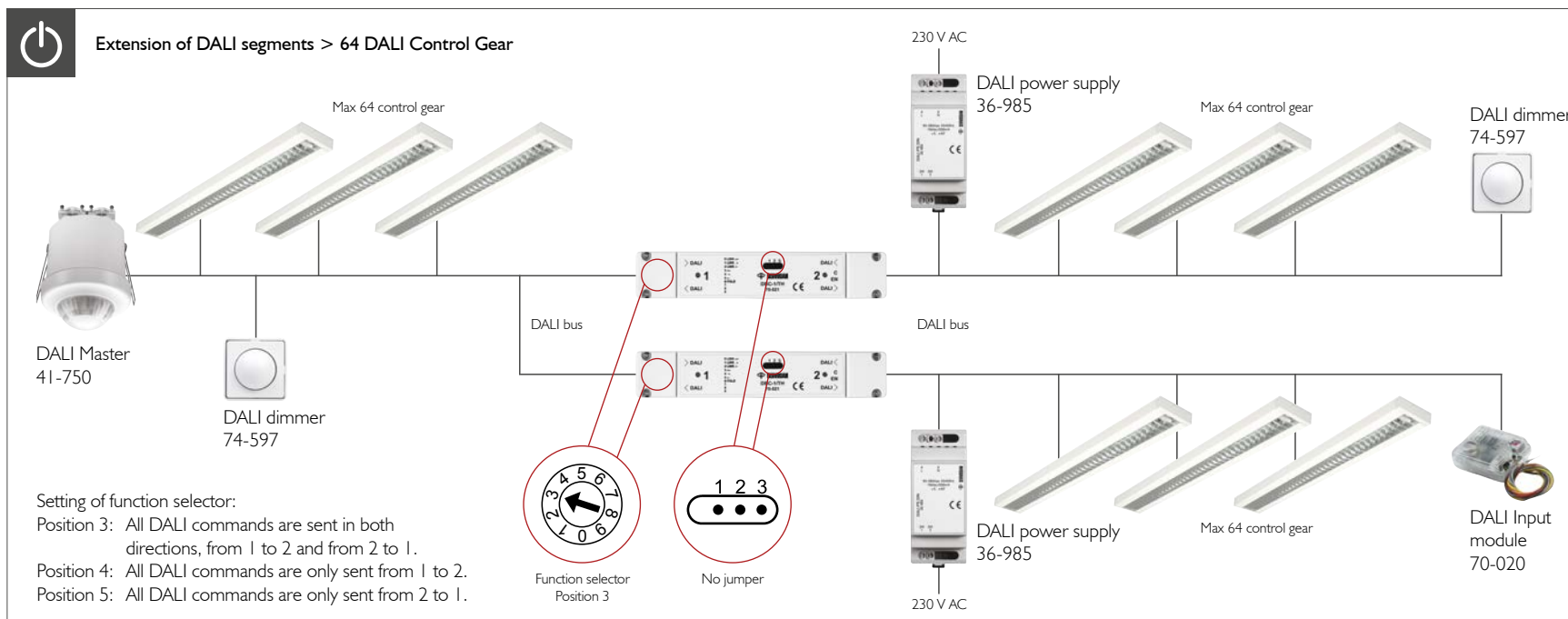

70-021 DBC-I/TH

DALI-linkmodul
DALI link module
DALI-Link-Modul
DALI module de liaison
DALI kopplingsmodul
DALI koblingen modul

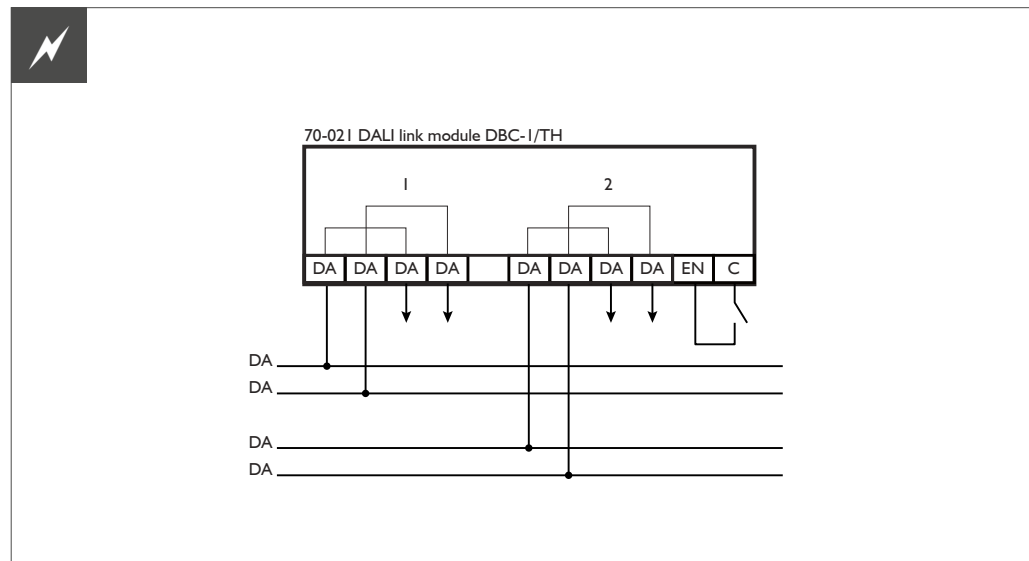

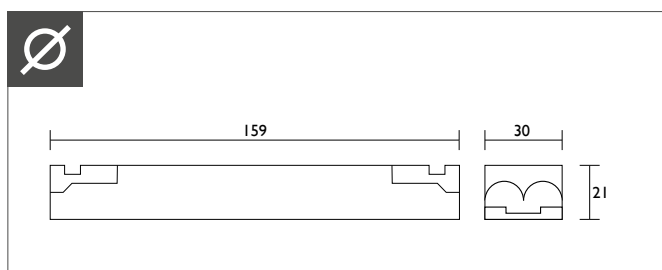
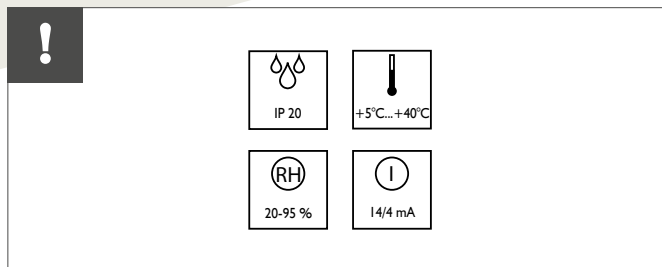

Neighbouring area

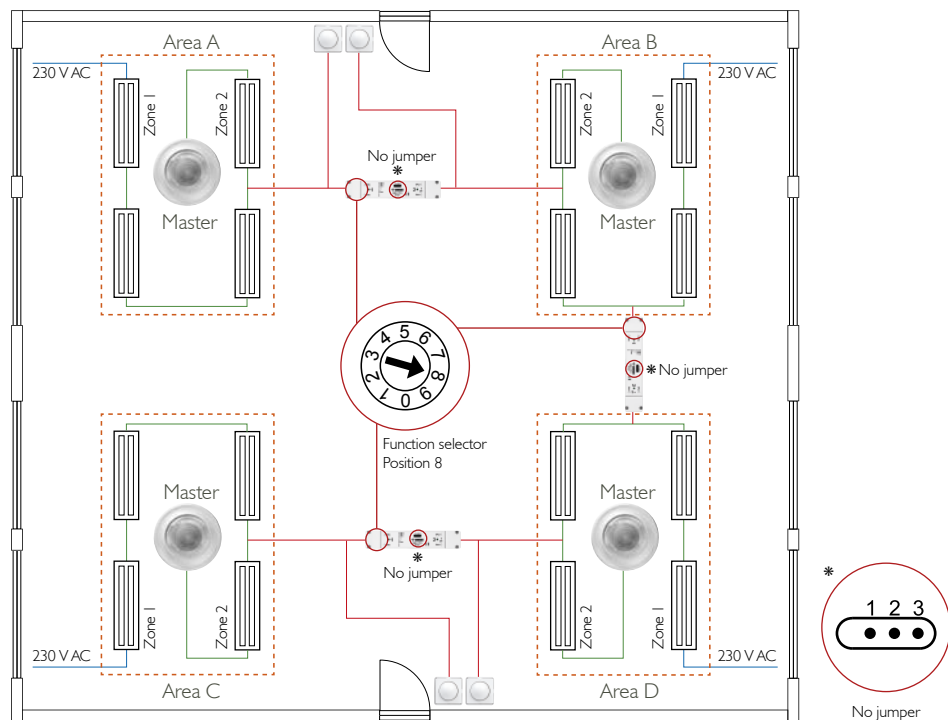

Setting of function selector:

7: neighbouring area = own daylight control

8: neighbouring area = 50% of own daylight control

9: neighbouring area = MIN. LEVEL

Setting of jumper:

Jumper [1-2] - 3 = All link commands are only sent from 1 to 2.

Jumper 1 - [2-3] = All link commands are only sent from 2 to 1.

No jumper = All link commands are sent in both directions, from 1 to 2 and from 2 to 1.



For further information about programming, status and operation - Scan QR code or see www.niko.dk/produkt/70-021



Folding door

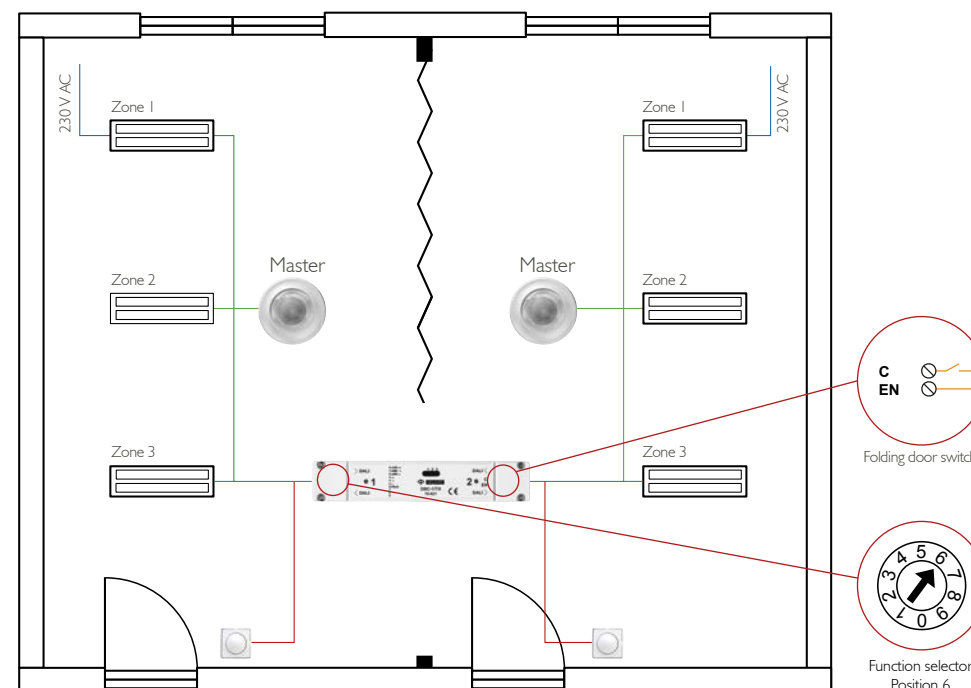

Setting of function selector:
6: Folding door

Folding door switch:

When the folding door is open, the folding door switch must be closed.

When the folding door is closed, the folding door switch must be open.



Advarsel: Indbygning og montering af elektriske apparater må kun foretages af aut. elinstallatør. Ved fejl eller driftsforstyrrelser kontakt den aut. elinstallatør. Ret til ændringer forbeholdes!

Warning: Installation and assembly of electrical equipment must be carried out by qualified electricians. Contact a qualified electrician in case of fault or breakdown. Reserving the right to make changes!

Warnung: Einbau und Montage elektrischer Geräte dürfen nur durch Elektrofachkräfte erfolgen. Wenden Sie sich bei Störungen bzw. Ausfall an einer Elektrofachkraft. Änderungen vorbehalten!

Avertissement: L'installation et le montage d'appareils électriques doivent exclusivement être exécutés par un électricien agréé. En cas de défaut ou de perturbation du fonctionnement, contacter un installateur électricien agréé. Sous réserve de modifications!

Varning: Elektriska apparater får endast byggas in och monteras av en auktoriserad elinstallatör. Kontakta den auktoriserade elinstallatören vid fel eller driftstörningar. Med reservation för ändringar!

Advarsel: Indbygning og montering af elektriske apparater må kun udføres af autoriseret elektriker. Autoriseret elektriker skal også kontaktes ved fejl eller driftsforstyrrelser. Det tas forbehold om endringer.