

# Outdoor motion detector 200°, 230 V, 14 m white

**351-26450**

**4** year  
warranty

This 1-channel outdoor motion detector with a detection range of 14 metres is suitable for use along driveways, under carports or in the garden. The motion detector can be mounted onto the ceiling or the wall and can be aimed upwards or downwards. The device has a built-in light sensor and switches the lighting automatically. After the pre-set time delay, the light is switched off automatically.



## Detection range

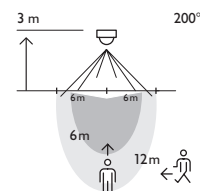

2 m	5 m	10 m
3 m	6 m	12 m
4 m	7 m	14 m
5 m	7 m	14 m
6 m	7 m	14 m
7 m	7 m	14 m
8 m	7 m	14 m



230 V



stand-alone



200 °



ø 14 m from  
a height of  
3 m



2 – 8 m



surface  
mounting

## Technical data

Article number	351-26450
Configuration	stand-alone
Input voltage	230 Vac $\pm$ 10 %, 50 Hz
Detector output	230 V (ON/OFF)
Relay contact	NO (max. $\mu$ 10 A)
Maximum load incandescent and halogen lamps ( $\cos\phi=1$ )	2300 W
Maximum load economy lamps (CFLi)	350 W
Maximum load LED lamps 230 V	350 W
Light intensity range	5 lux – 2000 lux
Number of channels	1 channel
Switch-off delay	pulse, 10 s – 20 min
Detection angle	200 °
Detection range (PIR)	$\varnothing$ 14 m from a height of 3 m
Ambient temperature	-20 – +55 °C
Mounting method	surface mounting
Mounting height	2 – 8 m
Dimensions visible (HxWxD)	94 mm
Dimensions (HxWxD)	63 x 63 x 94 mm
Wire capacity	NA
Protection degree	IP55
Marking	CE

## Accessories

350-41936	Universal remote control for smartphone
351-25320	IR remote control
351-25310	IR remote control for users

## Dimensions

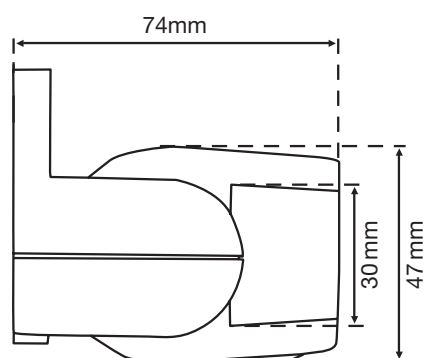

## Wiring diagram

