

# Motion detector, 230 V, 9 m, for flush-mounting box, white

350-100111

4 year warranty

The one channel motion detector is suitable for automatic indoor lighting control (on/off). It can be installed in a flush-mounting box in the ceiling. Spring clips and an IP54 surface-mounting box can be ordered separately. In conformity with the European directive for EMC and safety EN60669-2-1.  
Finishing colour: white

- Motion detector for standard applications
- Robust relay (300 W LED)
- Automatic or manual on/off
- Detection area can be modified by means of an adjustable cover mask
- IP54 surface-mounting box and spring clips available as accessories
- Commissioning via potentiometers
- Automatic or manual on/off



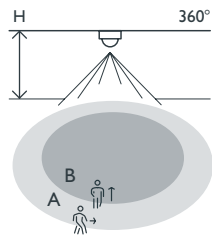

## Detection range





H	A Across	B Towards
2 m	ø 6.5 m	ø 4 m
2.5 m	ø 8 m	ø 5 m
3 m	ø 9 m	ø 6 m
3.5 m	ø 9 m	ø 6.5 m

  
230 V

  
stand-alone

  
360°

  
ø 9 m from  
a height of  
3 m

  
2 – 3.5 m

  
flush-  
mounting  
box

**niko**

## Technical data

Article number	350-100111
Input voltage	230 Vac $\pm$ 10 %, 50 Hz
Detector output	230 V (ON/OFF)
Maximum power consumption	0.5 W
Maximum MCB rating	10 A (limited by national installation rules)
Relay contact	N.O. (max. 10 A)
Maximum load incandescent and halogen lamps ( $\cos\phi = 1$ )	2300 W
Maximum load fluorescent lamps ( $\cos\phi \geq 0.5$ )	1200 VA
Maximum load economy lamps (CFLi)	800 W
Maximum load LED lamps 230 V	300 W
Maximum load electronic transformer	1200 VA
Maximum capacitive load	140 $\mu$ F
Light intensity range	10 lux – 2000 lux, $\infty$
Number of channels	1 channel
Switch-off delay	pulse, 30 s – 30 min
Detection angle	360°
Detection range (PIR)	$\varnothing$ 9 m from a height of 3 m
Ambient temperature	-20 – +45 °C
Mounting method	flush-mounting box
Mounting height	2 – 3.5 m
Colour	white (approximately RAL 9010)
Dimensions visible (HxWxD)	105 x 105 x 40.5 mm
Dimensions (HxWxD)	105 x 105 x 62.5 mm
Protection degree	IP20
Marking	CE

## Accessories

350-992901	IP54 surface-mounting box, white
350-991999	Flush-mounting box with spring clips

## Dimensions

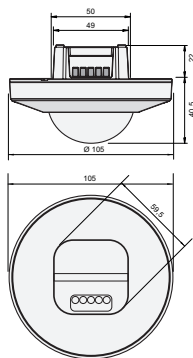

Wiring diagram

